

FORM NO. 1.

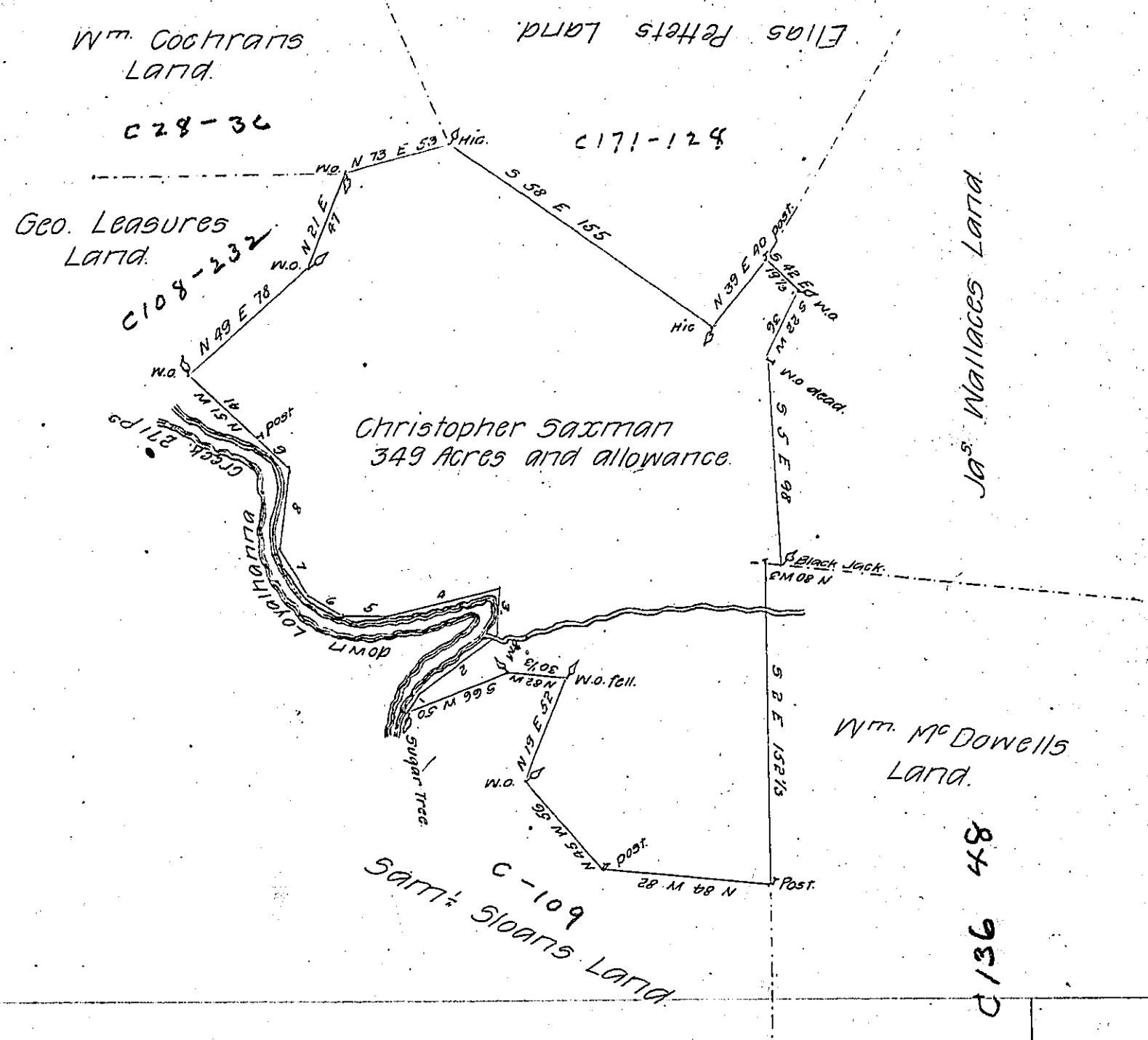

No. of Courses	Courses down Loyalhanna Creek	Distances
1	N 37 E 13	
2	N 52 E 46	
3	N 2 W 22	
4	S 75 W 58	
5	S 87 W 20	
6	N 72 W 20	
7	N 32 W 30	
8	N 6 E 38	
9	N 47 W 24	
Total Dist		271

In pursuance of a warrant dated Febr. 26th 1788 There was Survey'd for Christopher Saxman the above described tract of Land containing three hundred and forty nine acres with an allowance proportioned to six P Cent situate in Derry Township in the County of Westmoreland Survey'd May 9th 1788

P-John Moore D.S.

To John Lukens Esquire

Surv^r Gen^l of Penn^a

N.B. the land all round this tract is survey'd and if ^{the} return is rejected Mr. Saxman will be compelled to take the surplus at six pence P^r acre.

John Moore D.S.

IN TESTIMONY that the above is a copy of the original remaining on file in the Department of Internal Affairs of Pennsylvania, made conformably to an Act of Assembly approved the 16th day of February 1833, I have hereunto set my hand and caused the Seal of said Department to be affixed at Harrisburg, this twenty-second day of December 1906.

Loacn Brown
Secretary of Internal Affairs.